



1

Municipal Stormwater Regulatory Update

October 4, 2011

AWRA State Conference



2

Outline

Want to Provide Input? Next four months
Municipal Stormwater Permits Background
Reissuance Schedule
Major Topics
West Wash Manual Update
Other Guidance
Links and Resources

Municipal Stormwater

Stormwater is the leading contributor of pollution in rivers and streams

3

Soil, Sediment, Oils, Metals



Trash, Nutrients, Bacteria



Municipal Stormwater

Hydrologic changes impact waterbody health

4

Channel Destabilization & Low Flow Loss



Municipal Stormwater NPDES Program

5

- Permits are required to satisfy the **Clean Water Act's National Pollutant Discharge Elimination System Program**
- Ecology is authorized to administer program

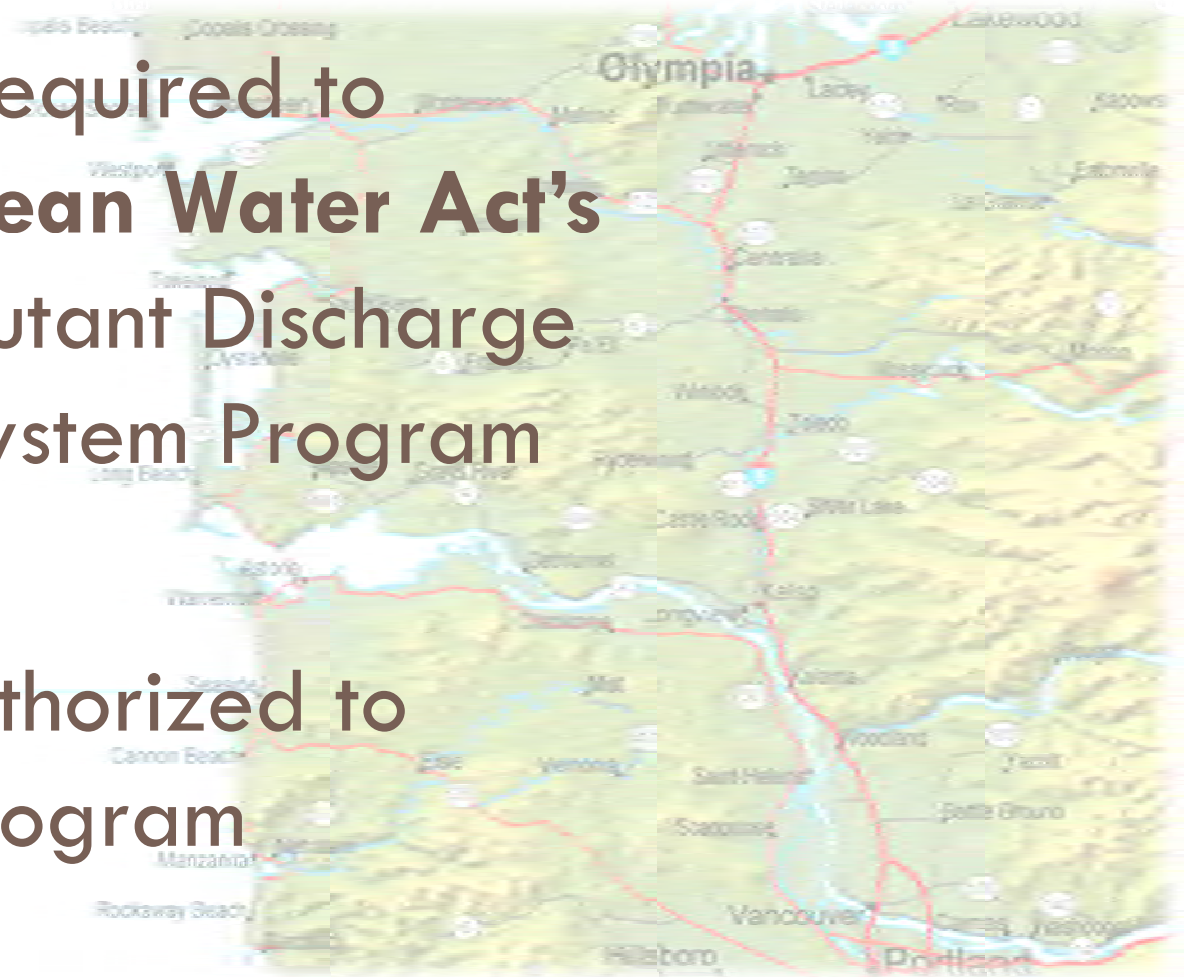

Statutes

6

Federal Clean Water Act

- Reduce discharge of pollutants to the “*maximum extent practicable*” (MEP)
- Prohibit non-stormwater discharges
- Develop a Stormwater Management Program



State Water Pollution Control Act (90.48 RCW)

- Protect Water Quality & apply *All Known Available and Reasonable methods of prevention, control and Treatment* (AKART)

Ecology issued the permits in Jan. 2007

6

Phase I

- 6 largest cities and counties
- Also Ports of Seattle and Tacoma

Phase II

- Eastern WA 18 cities & parts of 6 counties
- Western WA 80 cities and parts of 5 counties



Municipal Stormwater NPDES Permits

8

Permit Requirements

- Legal Authority
- Public Education & Outreach
- Public Involvement & Participation
- System Mapping
- Illicit Discharge Detection & Elimination
- New Development & Redev. Runoff Control
- Pollution Prevention & Operation and Maintenance
- Coordination
- Source Controls (Phase I)
- Structural Controls (Phase I)
- Monitoring





Permit Reissuance Schedule

April 2011 – Preliminary Drafts

October 19 – Public Release of Final Drafts

December – Workshops/Hearings East Wash

January – Workshops/Hearings West Wash

Early February – Close Public Comment

June – Reissue Permits

Permit Reissuance Major Topics

10

- LID Requirements
- Phase II Regulatory threshold
- Vesting
- Monitoring
- Impacts of these changes



Proposed LID Requirements

11

Overview

- ❑ Site/Subdivision Project Requirements
- ❑ Updates to Local Development Codes, Rules, Standards
- ❑ Watershed-scale Stormwater Planning

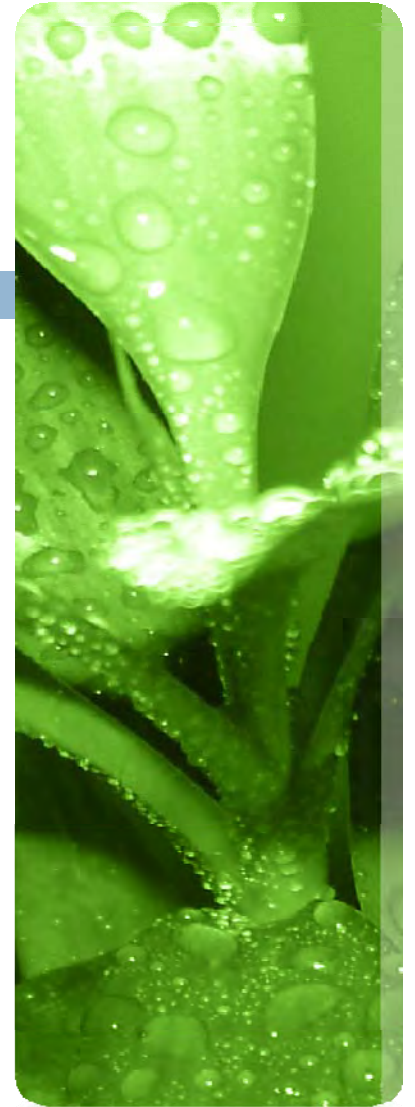
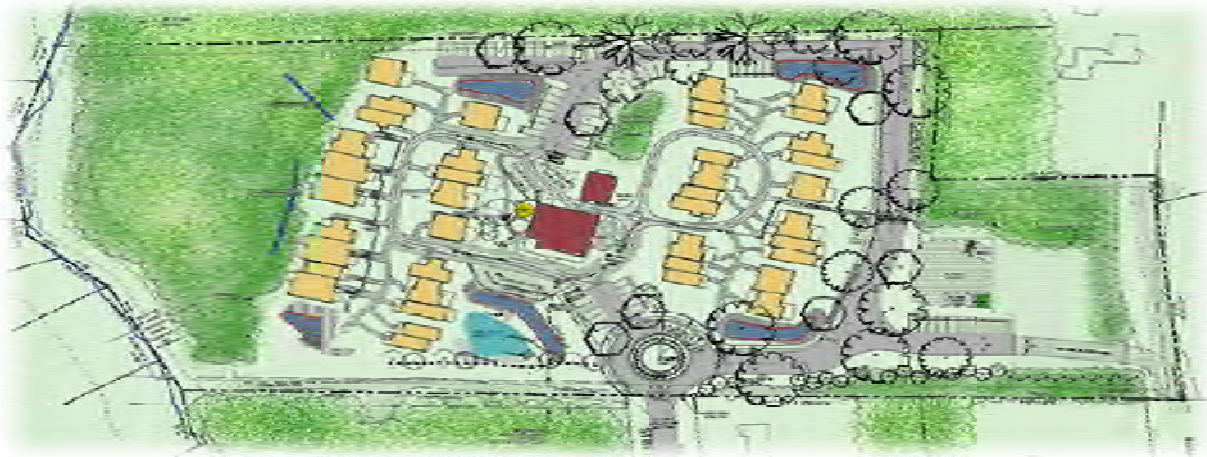

Proposed LID Requirements

12

Site/Subdivision Project Requirements



□ **LID required where feasible**

- Permeable Pavements
- Bioretention/rain gardens
- Green roofs (commercial only)
- OR match flow durations to 8% of 2-yr



□ **Feasibility defined**

- Site/engineering conditions
- Costs (for green roofs)
- Competing needs

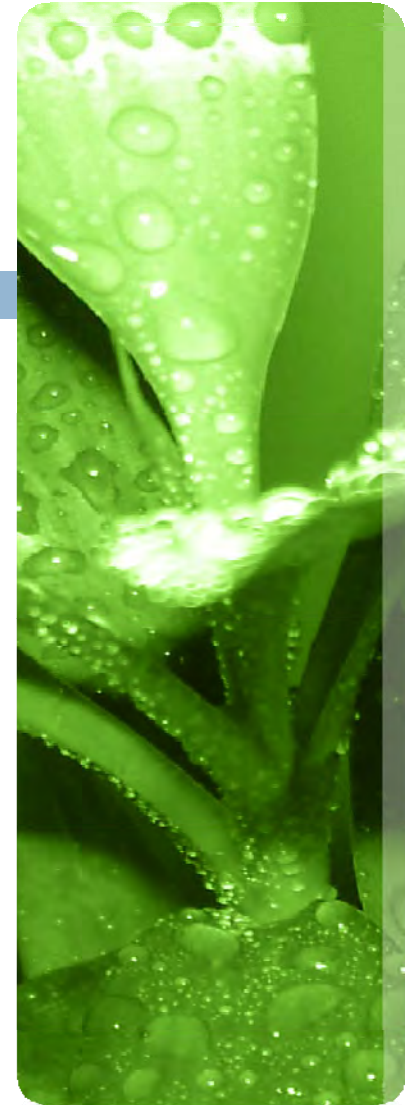

Proposed LID

13

Updates to Local Codes, Rules, Standards

- Review and revise codes to incorporate LID principles and BMPs to the “maximum extent practicable”
 - Follow process in *Integrating LID into Local Codes: A Guidebook for Local Governments*
 - Comprehensive plan
 - Zoning code
 - Development codes and standards

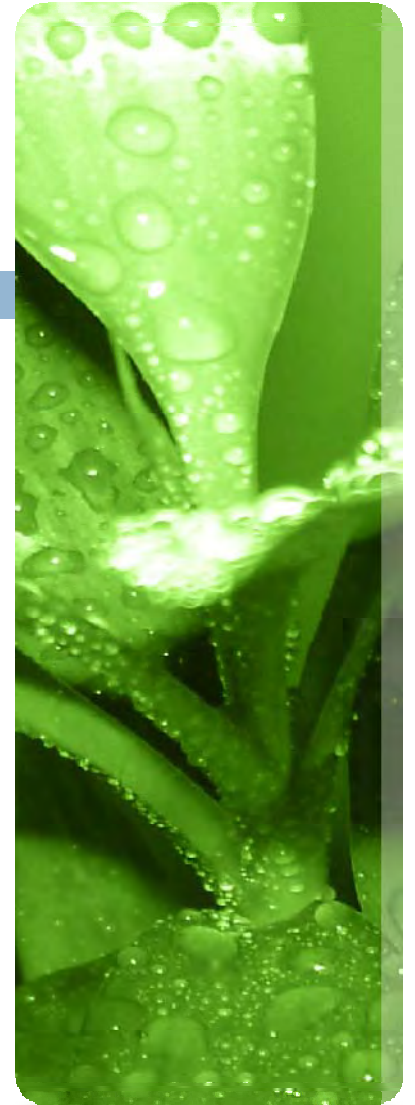

Proposed LID

14

Watershed-scale Stormwater Planning

~~☐ **Analysis triggers** (watersheds between 2 and 40 square miles)~~

~~☐ **Counties**~~

- ~~■ Expansion of UGA > 80 ac within watershed~~
- ~~■ Planned Land Use Action that increased TIA by $\geq 5\%$~~

~~☐ **Cities**~~

- ~~■ Expansion of city > 80 ac within watershed~~
- ~~■ Planned Land Use Action that increased TIA by $\geq 5\%$~~

~~—~~

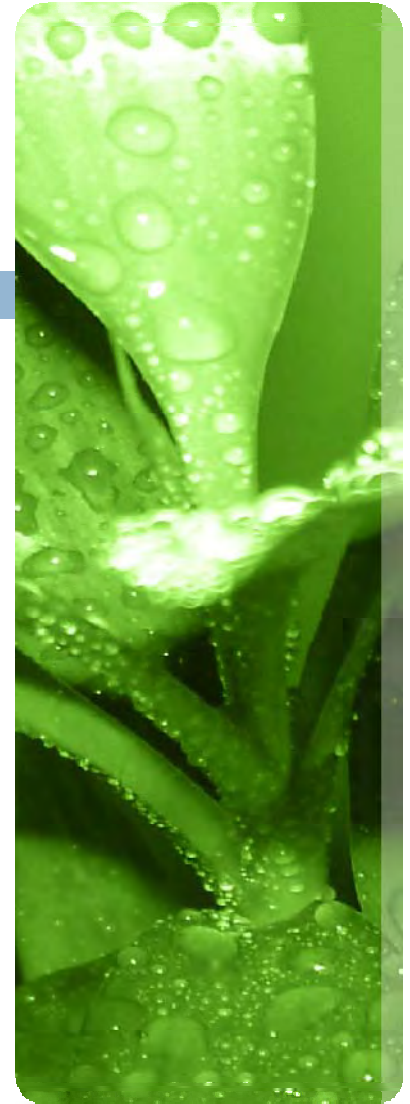



15

Outline

Have an Opinion? Focus for next few months

Municipal Stormwater Permits Background

Reissuance Schedule

Significant Issues

West Wash Manual Update

Other Guidance

Links and Resources

WW Manual Update

16

- ❑ October 19 – Public Release of Final Drafts
- ❑ January – Workshops West Wash
- ❑ Early February – Close Public Comment
- ❑ June – Publish Update



Manual Major Topics

17

- **Minimum Requirement for LID**
- **Site Planning**
 - **Soils & Hydrologic Analysis Procedures**
- **Treatment BMPs Update**
- **Source Control BMPs Update**



WWHM Update

18

- **Features**

- Windows 7 Operating System
 - Precipitation Update & 15 minute series
 - Auto Pond Update
 - LID Elements
 - Wetlands Modeling
-
- Operational – mid-year 2012
 - Users Manual & Training



Other Guidance

19

- Update LID Manual – late 2011/early 2012
- Publish “Integrating LID into Local Codes”
-Fall 2011
- Update Rain Garden Handbook - 2012



Links and Resources

- 2012 Municipal Stormwater Permit Reissuance
 - <http://www.ecy.wa.gov/programs/wq/stormwater/municipal/2012Reissuance.html>
 - <http://www.ecy.wa.gov/pubs/1110037.pdf>

- Integrating LID Into Local Codes: Guidebook
 - http://www.psp.wa.gov/LID_GLG.php

THANK-YOU

Ed O'Brien

eobr461@ecy.wa.gov